

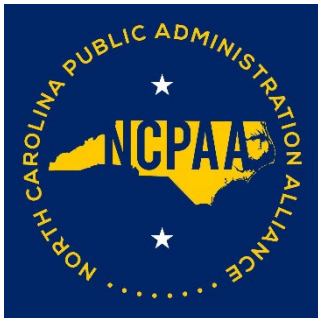

DEPARTMENT of PUBLIC AND INTERNATIONAL AFFAIRS

North Carolina Political Science Association

North Carolina
Political Science Association



North Carolina Public Administration Alliance

UNC Wilmington

March 24-25, 2023

*The 2023 Joint Meeting of the NCPSA and the NCPAA is proudly presented by
CIVIC Federal Credit Union*





DEPARTMENT of PUBLIC AND INTERNATIONAL AFFAIRS

*The Department of Public & International Affairs would like to express our sincere gratitude for the generous financial support from our presenting sponsor, **CIVIC Federal Credit Union.***



We also appreciate the support of:

Vice Chancellor Lowell Davis, Division of Student Affairs

Interim Dean Michelle Scatton-Tessier, College of Arts and Sciences

Office of University Relations

Office of Research and Innovation & SPARC

Wilmington and Beaches Convention & Visitors Bureau

The NCPSA and the NCPAA are also grateful for the amazing faculty, staff, and graduate teaching assistants in the Department of Public & International Affairs who have worked together to host this conference.

See the end of the program for a campus map, as well as building maps for the Fisher University Union and the Fisher Student Center.

NCPSA-NCPAA CONFERENCE PROGRAM – Panel Overview *(as of March 20)*

FRIDAY, MARCH 24

Check-In: Fisher University Union Town Square (*across from Post Office*) **12:00p-330p**

Session 1 **1:45p-3:15p**

Urban & Local Politics/Policy
Nonprofits & Environmental Politics
Undergraduate Research: American Politics & Public Policy
Roundtable: Research Collaboration - Lessons from the 2022 Cooperative Election Study

Session 2 **3:30p-4:45p**

International Relations
Pandemic Politics & Policy
Undergraduate Research: American Politics & Public Opinion
Roundtable: Teaching Methods in Public Affairs

Welcome Reception: Clocktower Lounge, Fisher Student Center **5:00p-6:30p**

SATURDAY, MARCH 25

Check-In: Fisher University Union Town Square (*across from Post Office*) **8:00a-330p**

Continental Breakfast: Outside Azalea Coast A&B, Fisher University Union **8:00a-9:00a**

Session 3 **9:00a-1030a**

Identity Politics
State & Local Politics: Elections
Roundtable: Preparing for Graduate School

Session 4 **10:45a-12:15p**

Comparative Politics in Asia & Political Theory
Public Administration & Management
Focus Group: Assessing the State of Public-Facing Academia

Lunch & Keynote Address: Warwick Center, Ballroom #1 **12:15p-2:00p**

Session 5 **2:15p-3:45p**

Comparative Politics
State Politics
Undergraduate Research: American Politics, Courts, and Elections

Session 6 **4:00p-5:30p**

Urban/Local Politics
Education: Policy and Practice
Undergraduate Research: International Relations
Roundtable: Election Administration in North Carolina

FRIDAY, MARCH 24

Check-In: Fisher University Union Town Square (*across from Post Office*)

12:00p-330p

Session 1

1:45p-3:15p

Urban & Local Politics/Policy

Carolina Beach Room – 2016 Fisher University Union

Resiliency in Emergency Management: A Case Study of Guilford County & the City of Greensboro

Samantha Allred, UNC Greensboro, graduate student, slallred2@uncg.edu

Kimia Hafezi, UNC Greensboro, graduate student, k_hafezi@uncg.edu

Hassan Sora, UNC Greensboro, graduate student, husora@uncg.edu

Tonya Williams, UNC Greensboro, graduate student, tmwilliams2@uncg.edu

Daniel Woods, UNC Greensboro, graduate student, diwoods@uncg.edu

Let's Make a Deal: Business Attraction Incentives and Home Prices

Adams Bailey, UNC Chapel Hill, graduate student, adamsbn8@email.unc.edu

Dr. Jeremy Moulton, UNC Chapel Hill, moulton@email.unc.edu

Dr. Scott Wentland, US Bureau of Economic Analysis, scott.wentland@bea.gov

How Does Media Consumption Affect Public Perceptions of Police?

Michaela Abbott, NC State, graduate student, meabbot3@ncsu.edu

National Special Security Events and Disruptions to Cities Transit Systems: Hidden Effects of Mega-events

Dr. Olga Smirnova, East Carolina, smirnovao@ecu.edu

Laura Antanaitis, Office of Budget & Strategy, Mecklenburg County, lantanai@uncc.edu

Dr. Suzanne Leland, UNC Charlotte, smleland@uncc.edu

Chair: Dr. Daniel Xu, East Carolina, xuh19@ecu.edu

Discussants: Dr. Daniel Xu, East Carolina, xuh19@ecu.edu & Dr. James Morone, Wake Forest, Moronej@wfu.edu

Nonprofits & Environmental Politics

Masonboro Island Room – 2011 Fisher Student Center

Diversity, Equity, and Inclusion in Hiring Leaders in Nonprofits

Beatrice Hunter, UNC Greensboro, graduate student, bhhunter@uncg.edu
Jaear McClendon, UNC Greensboro, graduate student, jdmcclen@uncg.edu
Michelle Slaton, UNC Greensboro, graduate student, msslanton@uncg.edu
Liz Welborn, UNC Greensboro, graduate student, ecshirley@uncg.edu

Management Issue: A Lack of Human Resources at Smaller Nonprofits

Michael Emeto, UNC Greensboro, graduate student, maemeto@uncg.edu
Million Mekonnen, UNC Greensboro, graduate student, mgmekonn@uncg.edu
Marshelle Pharr, UNC Greensboro, graduate student, mapharr@uncg.edu
Jessica Tefft, UNC Greensboro, graduate student, jctefftsora@uncg.edu

Show Me the Green: Local Sustainability Efforts

Robin Mikeal, UNC Charlotte, graduate student, rmckin10@uncc.edu

Chair: Dr. Jessica Weinkle, UNC Wilmington, weinklej@uncw.edu

Discussants: Dr. Jessica Weinkle, UNC Wilmington, weinklej@uncw.edu & Dr. Rich Clerkin, UNC Wilmington, clerkinr@uncw.edu

Undergraduate Research: American Politics & Public Policy

Azalea Coast Room A – 2001A Fisher University Union

The Role of Citizens in Zoning Policy

Aminah Jenkins, Meredith College, undergraduate student, asjenkins@email.meredith.edu

Moral Divisions: When Politics and Patriotism Enter Education

Elena Blackwelder, Meredith College, undergraduate student, emblackwelder@email.meredith.edu

Benefits of a Deregulated Energy Market for NC

Quentin Riddell, UNC Wilmington, undergraduate student, qrr2188@uncw.edu

Female Legislators and Gun Policy in America

Elizabeth Sharpe, Meredith College, undergraduate student, elizsharp@icloud.com

Chair: Dr. Martha Kropf, UNC Charlotte, mekropf@uncc.edu

Discussants: Dr. Martha Kropf, UNC Charlotte, mekropf@uncc.edu & Dr. Dillan Bono-Lunn, Elon University, dbonolunn@elon.edu

Roundtable: Research Collaboration - Lessons from the 2022 Cooperative Election Study

Azalea Coast Room B – 2001B Fisher University Union

Description: Join our interdisciplinary group of scholars to learn about our experience procuring, funding, and developing a UNCW module for the Cooperative Election Study, a nationally representative two-wave study of public opinion in the United States. We will discuss various aspects of our individual and collaborative projects, including the survey module. Whether you are interested in our research projects or curious about how you might get involved in the CES in the future, we look forward to sharing our experiences.

Host: Dr. John Brennan, UNC Wilmington, brennanj@uncw.edu

Panelists:

Dr. Nadine Gibson, UNC Wilmington, gibsonn@uncw.edu

Dr. Chris Prentice, UNC Wilmington, prenticecr@uncw.edu

Dr. Aaron King, UNC Wilmington, kinga@uncw.edu

International Relations

Masonboro Island Room – 2011 Fisher Student Center

Latent Second-strike and Enduring Nuclear Opaqueness: China's Manufactured Deterrence and Why it Has Worked

Dr. Hongyu Zhang, UNC Wilmington, zhangh@uncw.edu

Evaluating the Success of UN Peacekeeping

Hannah Wassil, UNC Wilmington, graduate student, hew4887@uncw.edu

Analysis of U.S-DRPK Relations and Success Determinants

Turner Nathaniel, App State, graduate student, turnerne3@appstate.edu

Militant Rhetoric: Abdul Nasser and the Six Day War

Matthew Ryan, UNC Wilmington, graduate student, mer7759@uncw.edu

Chair: Dr. Remy Kleinberg, UNC Wilmington, kleinbergr@uncw.edu

Discussants: Professor Remy Kleinberg, UNC Wilmington, kleinbergr@uncw.edu & Dr. Anup Phayal, UNC Wilmington, phayala@uncw.edu

Pandemic Politics & Policy

Carolina Beach Room – 2016 Fisher University Union

The Effects of Racial Concordance on COVID-19 Vaccine Hesitancy

Dr. Ashley Anderson, UNC Chapel Hill, aaanders@email.unc.edu

A New Resilience: Federal Employees Facedown the Pandemic Stress Test

Devon Adams, NC State, graduate student, dadams4@ncsu.edu

Dr. Dennis Daley, NC State, daley@ncsu.edu

Dr. Jerrell D. Coggburn, NC State, jcoggburn@ncsu.edu

Lessons about Health Equity from the COVID-19 pandemic

Dr. Elizabeth Fournier, St. Augustine's University, eafournier@st-aug.edu

The Effect of Social Isolation on Mental Health: Evidence from the UK COVID-19 Lockdown

Cecilia Rodriguez Ingold, UNC Chapel Hill, graduate student, rodriguezgold@gmail.com

Daniel Cho, UNC Chapel Hill, graduate student, danielcho@unc.edu

The Pandemic and Policy Elites?: What Strategies Influenced the Framing of COVID-19 Presidential Narratives?

Honey Minkowitz, NC State, graduate student, hminkow@ncsu.edu

Chair: Dr. Elizabeth Fournier, St. Augustine's University, eafournier@st-aug.edu

Discussants: Dr. Michael Munger, Duke University, mcmunger@gmail.com & Dr. Ngozi Kamalu, Fayetteville State University, nkamalu@uncfsu.edu

Undergraduate Research: American Politics & Public Opinion

Azalea Coast Room A – 2001A Fisher University Union

Climate Denialism as Ideology: The Roots and Implications of Denialism in Public Discourse

Rachel Crabb, App State, undergraduate student, crabbrachel3@gmail.com

'Stop the Steal' and other Lies: Partisan Cheerleading and Misinformation

Braden Ball, UNC Asheville, undergraduate student, bball3@unca.edu

The Pervasiveness of Misinformation on Social Media

Mason McVeety, UNC Wilmington, undergraduate student, mem4450@uncw.edu

Do All My Idols Go to Heaven? The Relationship Between Religiosity, Republicanism, and Political Idolization Behavior

Talula Dechev, UNC Wilmington, undergraduate student, tfd3208@uncw.edu

Chair: Dr. Whitney Manzo, Meredith College, wrmanzo@meredith.edu

Discussants: Dr. Whitney Manzo, Meredith College, wrmanzo@meredith.edu & Dr. David McLennan, Meredith College, dbmclennan@meredith.edu

Roundtable: Teaching Methods in Public Affairs

Azalea Coast Room B – 2001B Fisher University Union

Description: This panel will discuss current issues and approaches to teaching research methods in political science and public administration. Panelists will share their experiences teaching undergraduate and graduate methods courses with the goal of identifying trends in student needs, learning outcomes, and technology use (both in in-person and online modes of instruction). Similarities and differences in course content, assignments, and application of research methods beyond the classroom will be discussed. The second part of the panel will engage with the audience in clarifying what skills and knowledge sets our students need for the current job market world (e.g. data generation, management, analysis, interpretation, and technology competencies).

Host: Dr. Tatyana Ruseva, Professor, Department of Government & Justice Studies, Political Science MA Program, Appalachian State University, rusevatb@appstate.edu

Panelists:

Dr. Jason Giersch, Associate Professor, Department of Political Science and Public Administration, the University of North Carolina at Charlotte, jgiersch@uncc.edu

Dr. Kirsten Kinzer, Associate Professor, Department of Public and International Affairs, UNC Wilmington, kinzerk@uncw.edu

Dr. John Brooks, Assistant Professor, Department of Government & Justice Studies, MPA Program, Appalachian State University, brooksje1@appstate.edu

Dr. Brian Bulla, Associate Professor, Department of Government & Justice Studies, MPA Program, Appalachian State University, bullabr@appstate.edu

Welcome Reception

5:00p-6:30p

Clocktower Lounge – 2001 Fisher Student Center

SATURDAY, MARCH 25

Check-In: Fisher University Union Town Square (across from Post Office)

8:00a-330p

Continental Breakfast

8:00a-9:00a

Outside Azalea Coast A/B – 2001 Fisher University Union

Session 3

9:00a-1030a

Identity Politics

Azalea Coast Room A – 2001A Fisher University Union

The Future of Affirmative Action in the Wake of SCOTUS Decision in Fisher v. University of Texas (2016)

Dr. Ngozi Kmalu, Fayetteville State, nkamalu@uncfsu.edu

Race, Migration and the Changing Southern Voter

Dr. Christopher Cooper, Western Carolina, ccooper@email.wcu.edu

Dr. Scott Huffmon, Winthrop University, huffmons@winthrop.edu

Dr. H. Gibbs Knotts, College of Charleston, knottshg@cofc.edu

Dr. Seth McKee, Oklahoma State University, mckee@okstate.edu

Evolving Attitudes Towards Religion and Governance Among LGBTQ+ in the South

Dr. Scott Huffmon, Winthrop University, huffmons@winthrop.edu

Dr. Brandon Ranallo-Benavidez, Winthrop University, benavidez@winthrop.edu

Dr. Michael Sickels, Winthrop University, sickelsm@winthrop.edu

The Impact of Acculturation and Personal Discrimination on Latinx Public Opinion

Dr. Giovanni Pleites-Hernandez, UNC Asheville, gpleites@unca.edu

Dr. Rob Shrode, UNC Asheville, rshrode@unca.edu

Reverse Dog Whistle Politics: How Coded Language Softens White (Mis)Behavior

Dr. Tess Wise, Wake Forest University, wiset@wfu.edu

Kneshia Barlow, Wake Forest University, undergraduate student, barlkm19@wfu.edu

Chair: Dr. Scott Huffmon, Winthrop University, huffmons@winthrop.edu

Discussants: Dr. Tess Wise, Wake Forest University, wiset@wfu.edu & Dr. Ashley Anderson, UNC Chapel Hill, aaanders@email.unc.edu

State & Local Politics: Elections

Masonboro Island Room – 2011 Fisher Student Center

Polarization of North Carolina's Precincts: A Geographical Analysis of North Carolina Politics

Dr. Michael Bitzer, Catawba College, jmbitzer@catawba.edu

The 'Friends and Neighbors Effect' of Decreased Mobilization in Municipal Low Salient Minority Elections

Dr. Andre Smith, Fayetteville State, asmith158@uncfsu.edu

Does Politics Pay for Elections?

Dr. Martha Kropf, UNC Charlotte, mekropf@uncc.edu

Dr. Mary Jo McGowan, UNC Charlotte, MaryJoMcGowan@uncc.edu

Dr. Zachary T. Mohr, University of Kansas, zmohr@ku.edu

Chair: Dr. Nadine Gibson, UNC Wilmington, gibsonn@uncw.edu

Discussant: Dr. Nadine Gibson, UNC Wilmington, gibsonn@uncw.edu

Roundtable: Preparing for Graduate School

Carolina Beach Room – 2016 Fisher University Union

Description: Any undergraduate student who is considering the possibility of graduate school will benefit from hearing the experiences of faculty and graduate students from several programs around the state. This panel will also be interesting for faculty to learn about the student/faculty experience from across the state. Topics will include items like the transition from undergrad to graduate student, finances, life as a grad student, and career preparation.

Host: Dr. Mark Imperial, MPA Director, UNC Wilmington, imperialm@uncw.edu

Panelists:

Alya Busch, MPA Student & Teaching Assistant, UNC Wilmington, agb8350@uncw.edu

Michael Emeto, MPA Student & Research Assistant, UNC Greensboro, maemeto@uncg.edu

Cecilia Rodriguez Ingold, PhD Student in Public Policy, UNC Chapel Hill, rodriguezgold@gmail.com

Nicolas Reinhart, MPA Student & City of Wilmington Fellow, UNC Wilmington, njr5009@uncw.edu

Comparative Politics in Asia & Political Theory

Masonboro Island Room – 2011 Fisher Student Center

One Country, Two Systems, One City, Two Systems: Political Activism in Post-Colonial Hong Kong

Dr. Kofi Johnson, Fayetteville State, kjohnson@uncfsu.edu

The 20th CCP Congress: Is Xi All Powerful?

Dr. Han Lheem, Fayetteville State, hlheem@uncfsu.edu

Plato and Political Expertise

Dr. Josh Miller, UNC Charlotte, j.preston.miller@uncc.edu

Deven Cerda, UNC Charlotte, devencerda@gmail.com

Crafting the Pretext for War: An Analysis of Operation Northwoods as an Ethical Casus Belli

Dominik Faunce, UNC Charlotte, graduate student, pfaunce@uncc.edu

Power and Money

Nathaniel Willey, Winthrop University, undergraduate student, Willey3@icloud.com

Chair: Dr. Hongyu Zhang, UNC Wilmington, zhangh@uncw.edu

Discussants: Dr. Hongyu Zhang, UNC Wilmington, zhangh@uncw.edu & Dr. Ingrid Bego, Western Carolina, ibego@email.wcu.edu

Public Administration & Management

Carolina Beach Room – 2016 Fisher University Union

Emotional Labor: Does Personality-Job Fit Matter

Dr. Romeo Abraham, UNC Wilmington, abrahamr@uncw.edu

Dr. Varaidzo Zvobgo, Texas A&M International, varaidzo.zvobgo@tamiu.edu

Dr. Meghna Sabharwal, University of Texas-Dallas, mxs095000@utdallas.edu

Unraveling the Citizen-Customer Paradox: Bridging the Multiple Roles of Organizational Publics

Dr. Heather Rimes, Western Carolina, hnrimes@wcu.edu

Dr. Rebecca Nesbit, University of Georgia, nesbit7@uga.edu

Dr. Robert Christensen, Brigham Young University, rkc@byu.edu

Predicting Counterproductive Work Behaviors: The Interaction of Stressors, Emotions, and Narcissism

Joseph Amazuwa Chirwa, Northern Arizona University, graduate student, jac2272@nau.edu

Chirwa Towera, Northern Arizona University, tbc67@nau.edu

Result-based Accounting & Government Efficiency: The Moderating Role of IFMIS in Local Government Institutions

Joseph Amazuwa Chirwa, Northern Arizona University, jac2272@nau.edu

Chair: Dr. Jennifer Biddle, UNC Wilmington, biddlej@uncw.edu

Discussants: Dr. Jennifer Biddle, UNC Wilmington, biddlej@uncw.edu & Dr. Mark Imperial, UNC Wilmington, imperialm@uncw.edu

Focus Group: Assessing the State of Public-Facing Academia

Azalea Coast Room B – 2001B Fisher University Union

Description: Academics in our discipline have many teaching, research, and service obligations. This means faculty must often prioritize one dimension of their jobs over the others. In this focus group, I am interested to learn your perspective on public-facing scholarship. Is this something academics (and their institutions) should prioritize? What are the incentives to engage (or not engage) in these types of activities? Whether you participate in public-facing efforts or not, or if you want to learn more about the experiences of your colleagues, please join us for an interactive focus group.

Facilitator: Dr. Aaron S. King, UNC Wilmington, kinga@uncw.edu

Dr. Aaron S. King, NCPA President-Elect and Associate Professor of Political Science, UNCW

Dr. Jamie Winebrake, UNCW Provost and Vice Chancellor for Academic Affairs

Dr. Mark Imperial, NCPAA Board Member, UNCW MPA Director, and Professor of Public Administration

Dr. Angela Wright-Lanier, Executive Director for the Network of Schools of Public Policy, Affairs, and Administration (NASPAA)

NCPA/NCPAA Awards & Association Business

Dr. Angel Wright-Lanier is the executive director & CEO of the Network of Schools of Public Policy, Affairs, and Administration (NASPAA). NASPAA is a nonprofit 501(c)(3) membership association with over 300 institutional member schools at domestic and international universities that award degrees in Public Administration, Public Policy, Public Affairs, Nonprofit studies, and related fields. NASPAA is recognized as the global accreditor of master's degree programs in these fields.

Before joining NASPAA, Dr. Wright-Lanier was an assistant manager for Goldsboro, Mooresville, Fayetteville, and Cumberland County, North Carolina. During this time, she managed more than twenty-two different departments. She began her local government career as an operations analyst at the City of Raleigh in the Finance Department. After three years, she was promoted to the City Manager's office, where she was the city's first intergovernmental relations manager. Dr. Wright-Lanier successfully developed the city's first grants initiative, allowing her to work with department heads and the local Raleigh delegation to win millions of dollars in federal grants.

Dr. Wright-Lanier is a member of the International City/County Management Association (ICMA). She received her ICMA Credentialed Manager designation in 2018, and in 2021, Dr. Wright-Lanier received an ICMA Service Award in honor of her 20 years of service to local government.

Dr. Wright-Lanier received her undergraduate degree from The University of Tennessee, Knoxville. She has a master's degree in Public Administration from The University of Tennessee, Chattanooga, and a second master's degree in Management Information Systems. She was awarded her Ed.D. from Vanderbilt University's Peabody College with a concentration in Leadership and Learning.

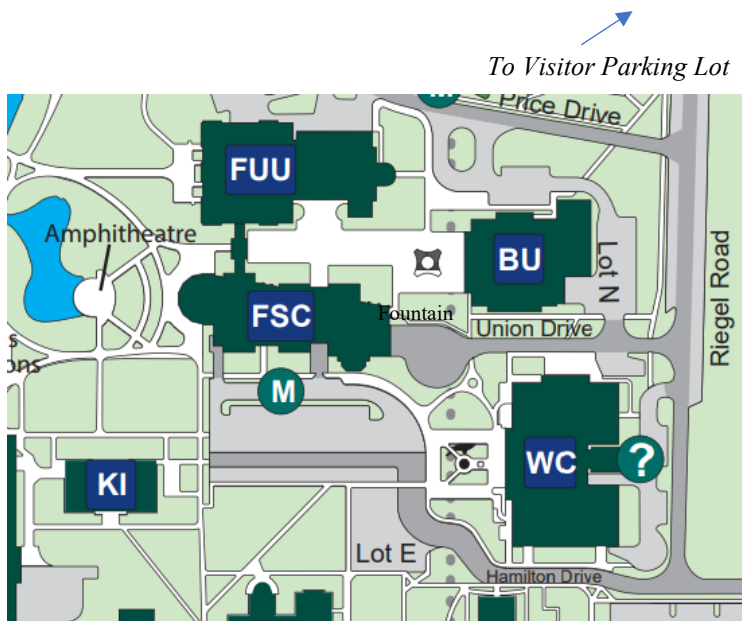

Our luncheon will take place in the Warwick Center (WC). If you depart the Fisher University Union (FUU) by walking past the Chic-fil-a, or if you leave the Fisher Student Center (FSC) by walking past the Starbucks, you will see a large fountain in front of the Burney Center (BU). Walk under the colonnade and you will see the Warwick Center. In a pinch, put "Warwick Center" in Google Maps!

Comparative Politics

Masonboro Island Room – 2011 Fisher Student Center

Trust in Traditional Authority Amid Fear and Democratization: Evidence from Somalia

Dr. Anup Phayal, UNC Wilmington, phayala@uncw.edu

Dr. Prabin Khadka, Essex University, prabin.khadka@essex.ac.uk

Post-conflict and Murder in Colombia 2012-2020, Local Farmers Facing on the Horns of a Dilemma

Giovanny Alvarez, UNC Chapel Hill, graduate student, giovanny@ad.unc.edu

The Rise of Populism and Women's Political Representation in Central and Eastern Europe: Ministerial Appointments to Executive Cabinets

Dr. Ingrid Bego, Western Carolina, ibego@email.wcu.edu

Chair: Dr. Jennifer Horan, UNC Wilmington, horanj@uncw.edu

Discussants: Dr. Jennifer Horan, UNC Wilmington, horanj@uncw.edu & Dr. Ingrid Bego, Western Carolina, ibego@email.wcu.edu

State Politics

Carolina Beach Room – 2016 Fisher University Union

Acculturation, Hispanic Ethnicity, and Trust: Verifying and Explaining Racial/Ethnic Differences in Trust in Health Providers in North Carolina Medicaid

Dr. Galen Smith, UNC Charlotte, ghsmith@uncc.edu

Dr. Cicily Hampton, Virginia University of Lynchburg, cicily.hampton@gmail.com

Dr. Hollie L. Tripp, Franklin and Marshall University, hollie.tripp@fandm.edu

Dr. William P. Brandon, UNC Charlotte, wilbrand@uncc.edu

Examining the Impact of Anti-Union Legislation in Wisconsin: A Case Study Using Synthetic Control

Dr. Dillan Bono-Lunn, Elon University, dbonolunn@elon.edu

Perceptions of Polarization in North Carolina

Dr. Whitney Manzo, Meredith College, wrmanzo@meredith.edu

Dr. David McLennan, Meredith College, dbmclennan@meredith.edu

Chair: Dr. Giovanny Pleites-Hernandez, UNC Asheville, gpleites@unca.edu

Discussants: Dr. Giovanny Pleites-Hernandez, UNC Asheville, gpleites@unca.edu & Dr. Andre Smith, Fayetteville State, asmith158@uncfsu.edu

Undergraduate Research: American Politics, Courts, and Elections

Azalea Coast Room A – 2001A Fisher University Union

The Changing Character and Significance of North Carolina Judicial Selection

Jedediah Calvert, Western Carolina, undergraduate student, jjcalvert1@catamount.wcu.edu

Mackenzie Pritchard, Western Carolina, undergraduate student, mrpritchard1@catamount.wcu.edu

Collin Semrad, Western Carolina, undergraduate student, casemrad1@catamount.wcu.edu

Presidential Response to Supreme Court Decisions

Deborah Harris, UNC Wilmington, undergraduate student, dkh6348@uncw.edu

Presidential Elections: France and America. The Difference Between Donald Trump and Marine Le Pen in the 2016 and 2017 Elections

Paris Rogers, UNC Wilmington, undergraduate student, phr5687@uncw.edu

The Great Replacement Theory in the 2022 Midterm Elections: An Examination of Republican Senatorial Nominees' Online Rhetoric

Christian Peterson, Davidson College, undergraduate student, chpeterson@davidson.edu

Chair: Dr. Stephen Meinhold, UNC Wilmington, meinholds@uncw.edu

Discussants: Dr. Stephen Meinhold, UNC Wilmington, meinholds@uncw.edu & Dr. Michael Bitzer, Catawba College, jmbitzer@catawba.edu

Urban/Local Politics

Carolina Beach Room – 2016 Fisher University Union

From Protest to Property: The Transformation of Neighborhood-Based Activism, and Its Effects on Local Political Cultures

Dr. James Morone, Wake Forest University, Moronej@wfu.edu

The Local E-Government in North Carolina: A Preliminary Assessment of County Government

Dr. Daniel Xu, East Carolina University, xuh19@ecu.edu

Mehak Rathore, East Carolina University, graduate student, rathorem22@students.ecu.edu

Addressing Food Deserts in New Hanover County, North Carolina

Adam Moran, UNC Wilmington, graduate student, amm5400@uncw.edu

Chair: Dr. Olga Smirnova, East Carolina, smirnovao@ecu.edu

Discussants: Dr. Olga Smirnova, East Carolina, smirnovao@ecu.edu & Michaela Abbott, NC State, graduate student, meabbot3@ncsu.edu

Education: Policy and Practice

Masonboro Island Room – 2011 Fisher Student Center

Political Parties and the Boards of NC School Districts and Charter Schools

Dr. Jason Giersch, UNC Charlotte, jgiersch@uncc.edu

Taking Stock in Teaching Tools: An Analysis of Required Readings in Public Human Resource Management Courses

Katie Glover, NC State, graduate student, klglove2@ncsu.edu

Relationships and Spillovers: Higher Education Institutions and the Adoption of Community Sustainability Practices

Bich Ha Vien, NC State, graduate student, bvien@ncsu.edu

Dr. Christopher Galik, NC State, csgalik@ncsu.edu

The Case Study Approach in Public Administration and Political Science Education: A Path Not Taken

Dr. John Brennan, UNC Wilmington, brennanj@uncw.edu

Chair: Dr. John Brennan, UNC Wilmington, brennanj@uncw.edu

Discussants: Dr. John Brennan, UNC Wilmington, brennanj@uncw.edu & Dr. Jason Giersch, UNC Charlotte, jgiersch@uncc.edu

Undergraduate Research: International Relations

Azalea Coast Room A – 2001A Fisher University Union

A Critical Analysis of the US-Mexico Border: The Risk of Unfettered Access

Abigail Cameron, UNC Wilmington, undergraduate student, amc9700@uncw.edu

Resource Curse of Venezuela

Joshua Green, UNC Chapel Hill, undergraduate student, tejoshua@live.unc.edu

Haitian & Dominican Relations: The Challenges of Haitian Immigration

Cabral Jeter, NC A&T, undergraduate student, cdjeter@aggies.ncat.edu

An Analysis of the Russo-Japanese Dispute Over the Kuril Islands: Strategic Interests or Failure?

Nikita Samoylenko, UNC Wilmington, undergraduate student, nms3770@uncw.edu

Chair: Matthew Ryan, UNC Wilmington, graduate student, mer7759@uncw.edu

Discussants: Matthew Ryan, UNC Wilmington, graduate student, mer7759@uncw.edu & Turner Nathaniel, graduate student, App State, turnerne3@appstate.edu

Roundtable: Election Administration in North Carolina

Azalea Coast Room B – 2001B Fisher University Union

Description: Join us for a discussion on election administration in North Carolina, with a focus on research opportunities, practical applications, and the work of the bipartisan North Carolina Network for Fair, Safe, and Secure Elections.

Host: Dr. Christopher Cooper, Western Carolina, ccooper@email.wcu.edu

Participants:

Dr. Martha Kropf, UNC Charlotte, mekropf@uncc.edu

Dr. Michael Bitzer, Catawba College, jmbitzer@catawba.edu

FISHER STUDENT CENTER (2nd Floor)



FISHER STUDENT CENTER 2ND FLOOR	
	BOOKSTORE
	CLOCKTOWER LOUNGE
	RESTROOMS
	ELEVATORS
	SKYBRIDGE
	TOPSAIL ISLAND
	WRIGHTSVILLE BEACH
	SAFFO
	MASONBORO
	CAIC
	STAIRS
	ENTRANCE
	EXIT

FISHER UNIVERSITY UNION (2nd Floor)

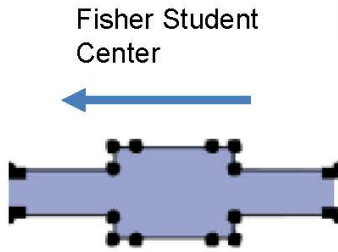

FISHER UNIVERSITY UNION 2ND FLOOR	
	CAMPUS LIFE
	CAREER CENTER
	RESTROOMS
	ELEVATORS
	BOSEMAN GALLERY
	UPPERMAN CENTER
	CENTRO HISPANO
	LA SALA
	AZALEA COAST
	CONFERENCES, EVENTS & RESERVATIONS
	TRANSITION PROGRAMS
	CAROLINA BEACH
	STAIRS
	ENTRANCE
	EXIT

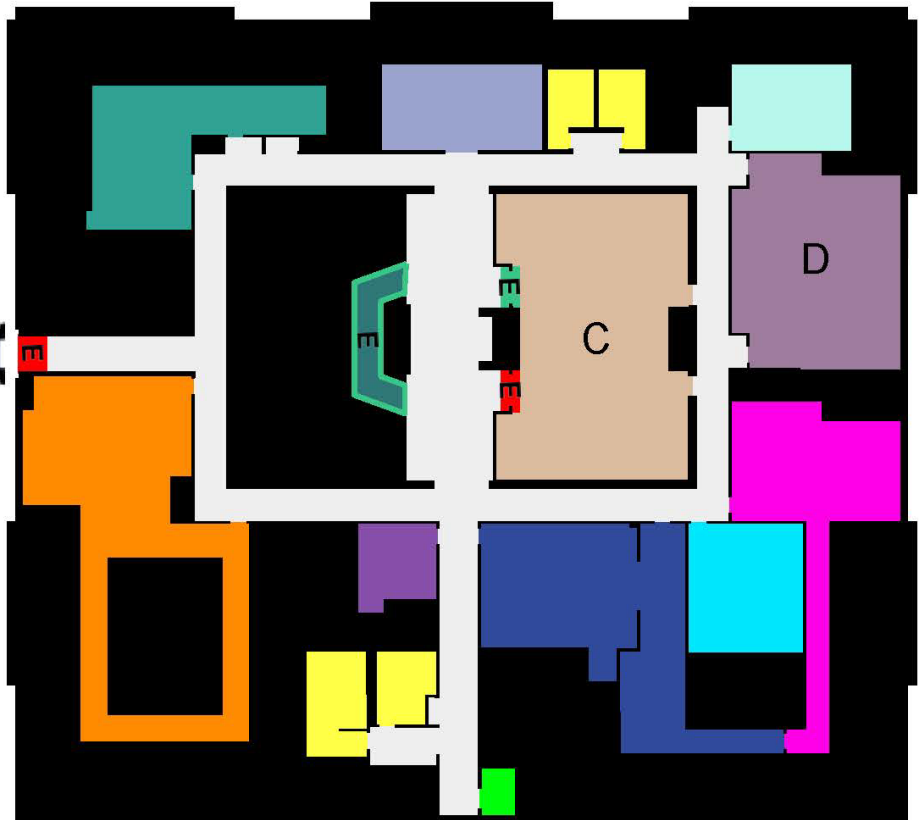

UNIVERSITY of NORTH CAROLINA WILMINGTON

601 SOUTH COLLEGE ROAD, WILMINGTON, NC 28403



Rev. 01.2023

Building	Code	Location	Building	Code	Location
Academic Support Center	AS	E2	Kenan Hall	KE	C-D7
Administrative Annex	AD	H8	Keystone House	HH	B1-2
Alderman Hall	AL	D7	King Hall	KI	C-D6
Almkuist-Nixon	AN	F7	Leonard Student Recreation Center	SRC	D2-3
Bear Hall	BR	B6	Leutze Hall	LH	C5
Belk Hall	BK	E4	Loggerhead Hall	LO	F3
Burney Center	BU	E6	McNeill Hall	MC	C3
Cameron Hall	CH	C4	Morton Hall	MO	C6
Central Parking Deck	CP	E4	Nixon Annex	NX	E-F7
Coastal Engineering Building	CE	B5	Pelican Hall	PE	E3-4
Congdon Hall	CG	C5	Printing Services	PS	F1
Cornerstone Hall	CS	B2	Randall Library	RL	C6
Cultural Arts Building	CA	A4	Recycling Depot	RD	E-F1
DeLoach Hall	DL	C7	Sandpiper Hall	SA	E3
DePaolo Hall	DE	D7	Sartarelli Hall	ST	C5
Dobo Hall	DO	C4	Schwartz Hall	SZ	D2
East Parking Deck	EP	B3	Seahawk Crossing	SC	B2-3
Education Building	EB	B4	Seahawk Landing	SL	A1-2
Fisher Student Center (Bookstore)	FSC	D6	Seahawk Village	SV	C-D1
Fisher University Union	FUU	D5-6	Shops at the Crossing	SH	B3
Friday Annex	FA	B4-5	Teaching Laboratory Building	TL	C3
Friday Hall	FR	B5	Terrapin Hall	TE	E3
Galloway Hall	GA	F4	The Shore Dining Hall	SO	D3-4
Graham Hall	GR	F3	Trask Coliseum	TR	E7
Hanover Hall	HA	E7	University Film Center	FI	F1
Hewlett Hall	HE	F3	University Police Department	PD	F2
Hoggard Hall	HO	D7	University Suites	US	D2
Housing and Residence Life	HRL	D2	Veterans Hall	VH	C3
Innovation House	IH	B2	Visitor Information & Parking	VB	E5
Isaac Bear	IB	H7	Wagoner Hall (Dining Hall)	WA	C2
James Hall (Admissions)	JA	E7	Warehouse	WH	E1
Kenan Auditorium	KA	C7	Warwick Center (Financial Aid)	WC	E6